

NOTES: (UNLESS OTHERWISE SPECIFIED)

- ALL DIMENSIONS ARE IN mm OTHERWISE NOTED.
- LINEAR SPECIFICATION:**
 LINEAR STROKE: 25 +1.0/-0 mm
 FORCE CONSTANT: 10 N/AMP
 PEAK FORCE: 12.5 N @ 1.3 AMPS (48 VDC)
 CONTINUE FORCE : 10 N @1 AMPS (48 VDC)
 COIL DC RESISTANCE: 31 OHMS @ 22°C
 COIL INDUCTANCE: 4.12 mH @ 1 kHz
 ENCODER RESOLUTION: 0.5, 1.0, 5.0 Microns
 ENCODER ACCURACY: ±4 COUNTS
- MOVING MASS: 120 GRAMS
- TOTAL MASS: 950 GRAMS
- OPERATING TEMPERATURE: 0°C TO +65°C

SIGNATURE NEEDED FOR ORDER APPROVAL
 SIGN _____ DATE _____
 APPROVAL NOT RECEIVED WITHIN
 48 HOURS MAY AFFECT DELIVERY

REVISIONS				
REV	DATE	ECN	DESCRIPTION	APP
A	9/29/03	2923	INITIAL RELEASE	GK
B	10/13/04	3354	SEE ECN ***	CAW
C	8/27/04	3310	SEE ECN	CAW
D	10/1/13	5288	SEE ECN	KGS
E	1/15/16	5688	PART NUMBER CHANGE	SB

DB-26P PINOUT

1	(L) PH. A+
2	(L) PH. B+
3	(L) PH. Z+
4	NC
5	NC
6	I/O RTN
7	NC
8	NC
9	NC
10	(L) PH. A-
11	(L) PH. B-
12	(L) PH. Z-
13	NC
14	LIMIT +
15	LIMIT -
16	NC
17	NC
18	NC
19	+5VDC
20	5V RTN
21	(L) COIL +
22	(L) COIL +
23	(L) COIL -
24	(L) COIL -
25	NC
26	NC

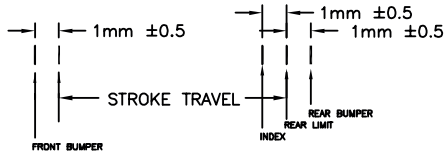
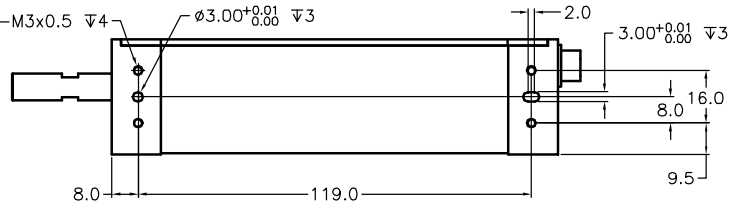
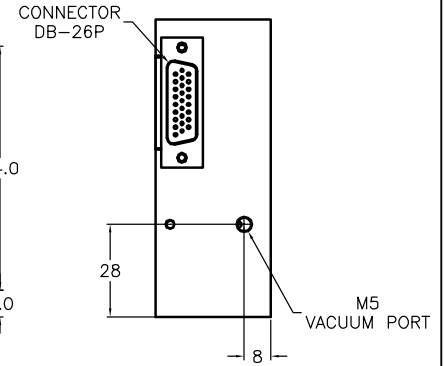
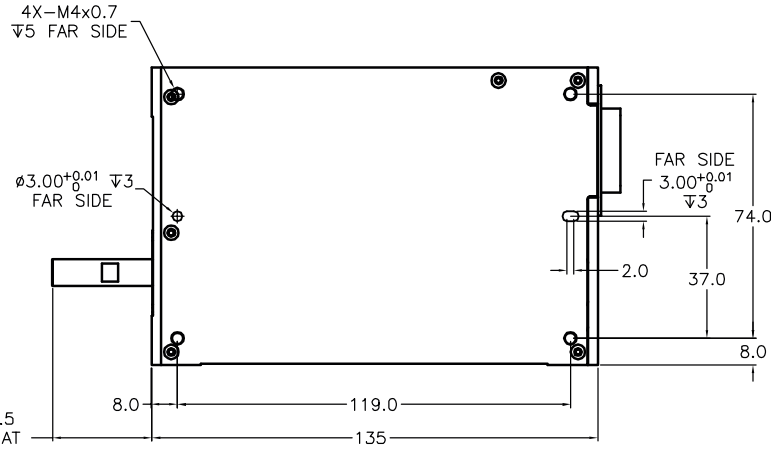
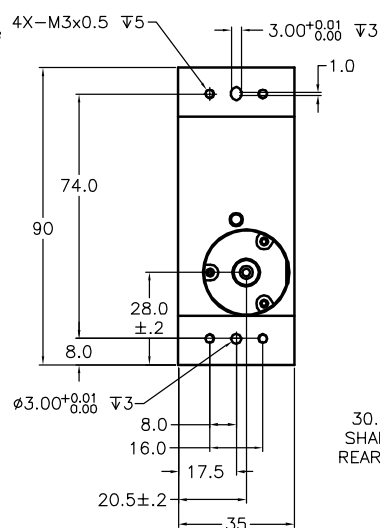

TOLERANCES ARE:	MATERIAL:
X. ± 0.50	ALUMINUM
X.X ± 0.1	6061-T6
X.XX ± 0.05	HEAT TREAT: RC
X.XXX ±	DEEP
ANGULARITY ± 0.1°	MACHINE FINISH: 1.6
CONCENTRIC ± 0.01	EXCEPT NOTED.
ROUNDNESS ± 0.05	PROTECTIVE FINISH: ELECTROLESS NICKEL
EDGE BREAK 0.02 MAX	FILE NAME: LAL35-025-7
CHAMFER 0.03 MAX	SPEC. NUMBER:

SMAC				REF. NUMBER	
				LAL35-025-7	
DESIGNED BY: KAMBARA	DATE: 09/26/03	CHECKED BY:	DATE:	CONTRACT: STD	
DRAWN BY: GORO/KGS	DATE: 10/1/13	APPROVED BY:	DATE:	SHEET NUMBER: 1 OF 1	
PART NAME: LAL35-025-7X-1				REVISION: E	
SCALE: NONE	DWG SIZE: B	PART NUMBER: LAL35-025-7X-1			
DO NOT SCALE DWG					

