

NOTES (UNLESS OTHERWISE SPECIFIED)

- 1. LINEAR SPECIFICATIONS:
 ENC. RESOLUTION(+A/-A;+B/-B): 5, 1, 0.5 um
 ENCODER REPEATABILITY: ± 3 encoder counts
 INDEX LOCATION(+Z/-Z): 2 ± 1 TO R.H.S
 OPERATING VOLTAGE: 48 Vdc
 POLE PITCH: 47.8mm
- 2. VACUUM OPTION: YES
- 3. SPRING OPTION: TBD
- 4. OPERATING TEMPERATURE: 0°C TO 40°C
- 5. PLATING: BLACK CERAKOTE
- 6. ALL DIMENSIONS AND DETAIL SPECT MAY SUBJECT TO CHANGE WHEN PROTOTYPE

REVISIONS				
REV	ECR	DESCRIPTION	DATE	APPROVED

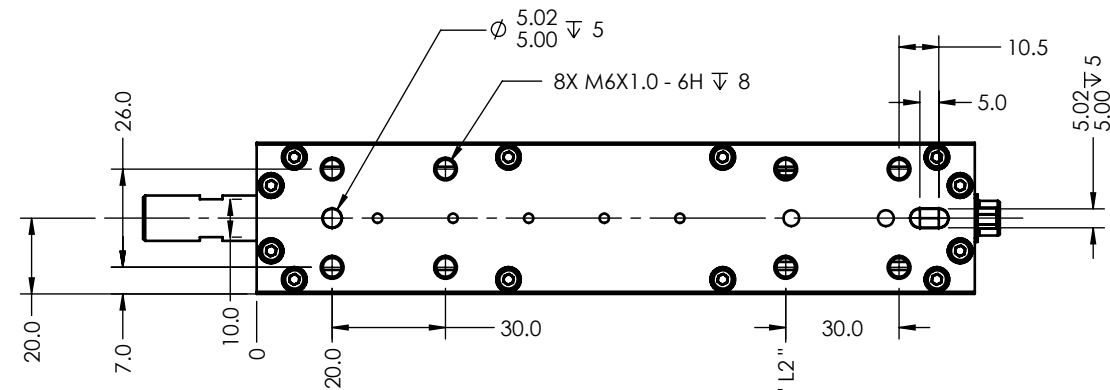
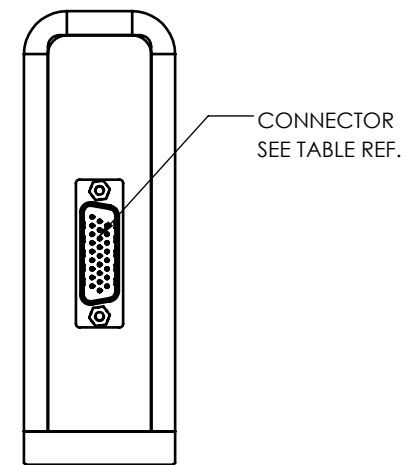
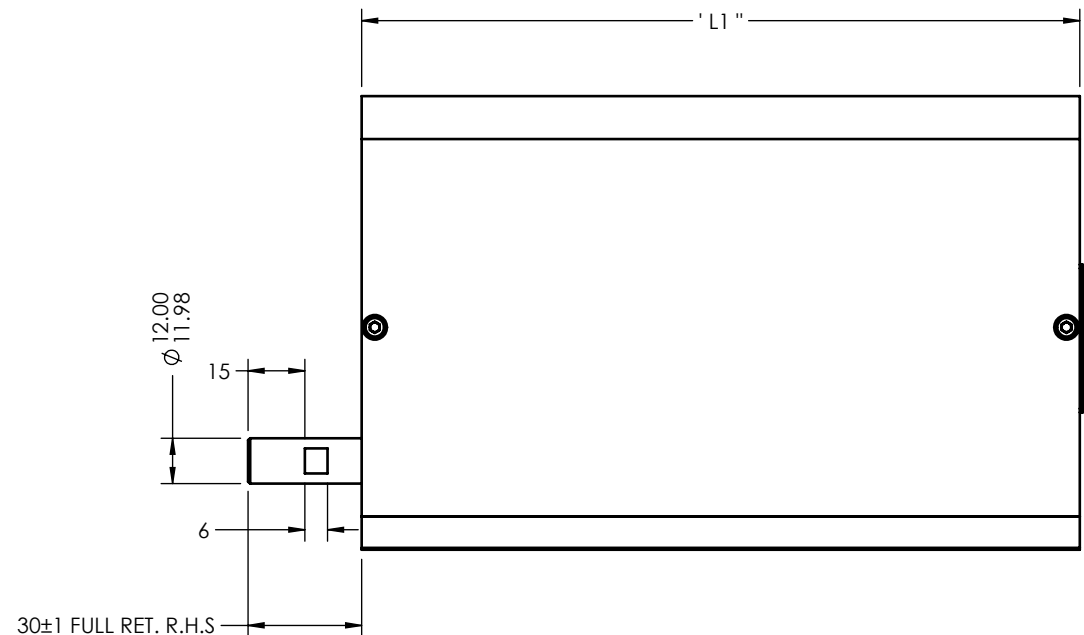
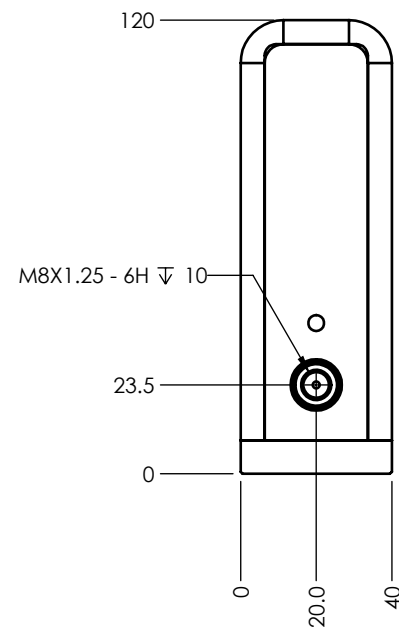

PIG TAIL CABLE (0.5m LG)

PIN No	HDB-26P
1	(L) PH. A+
2	(L) PH. B+
3	(L) PH. Z+
4	NC
5	NC
6	NC
7	NC
8	NC
9	NC
10	(L) PH. A-
11	(L) PH. B-
12	(L) PH. Z-
13	NC
14	NC
15	NC
16	NC
17	NC
18	NC
19	+5 VDC
20	5V RTN
21	(L) MOTOR+
22	(L) MOTOR+
23	(L) MOTOR-
24	(L) MOTOR-
25	NC
26	NC

No	UNIT	DETAILS	LDL40C-050-3X-3	LDL40C-025-3X-3	LDL40-050-3X-3	LDL40-100-3X-3	LDL40C-100-3X-3
1	mm	LINEAR STROKE	50	25	50	100	100
2	N	PEAK FORCE	100	100	100	100	100
3	N/A	FORCE CONST	40	40	40	40	40
4	A	PEAK CURRENT	2.5	2.5	2.5	2.5	2.5
5	Ohm	TERM. RESISTANCE	22	22	22	22	22
6	mH	INDUCTANCE	6	6	6	6	6
7	kg	MOVING MASS	0.50	0.45	0.50	.55	.55
8	kg	TOTAL MASS	4.5	3.9	4.0	5.2	5.6
9	mm	DMENSION L1	225	190	190	250	285
10	mm	DMENSION L2	140	140	140	200	235

REF. NUMBER	LDA40
CONTRACT	LDA40

UNLESS OTHERWISE SPECIFIED
 ALL DIMENSIONS ARE IN MM
 BREAK EDGES AND REMOVE BURRS
 TOLERANCES
 X: ±0.5 X.X: ±0.1
 X.XX: ±0.03 ANGLE: ±0.1°
 CONCENTRICITY: ±0.025
 ROUNDNESS: ±0.025
 EDGE BREAKS: 0.2 MAX
 ALL DIMENSIONS AND TOLERANCES ARE FINAL

MATERIAL:	NAME	DATE
FINISH:	DWN BY	TV 09/20/21
MACHINE FINISH: 1.6/√	CHK BY	TV 09/20/21
INTERPRET PER: ASME Y14.5-2009	ENG APP	TV 11/23/21
THIRD ANGLE PROJECTION	MFG APP	
	QA APP	

SMAC 5807 VAN ALLEN WAY
 CARLSBAD CA, 92008
 (760) 929-7588

MOVING COIL ACTUATORS

TITLE: **LDL40-XXX-3Y-3**

SIZE: B PART NO: **LDL40-XXX-3Y-3** REV: **C**

SCALE: 1:2 DO NOT SCALE SHEET: 1 / 2

REVISIONS				
REV	ECR	DESCRIPTION	DATE	APPROVED

CABLE: FLYING LEAD (3m LG)

J2 - DB-15P CONN.		J3 - PHOENIX CONN.	
PIN	DETAIL	PIN	DETAIL
1	A+	1	GND
2	Z+	2	+V
3	B+	3	MU
4	+5VDC	4	MV
5	NC	5	MW
6	NC	6	GND (SHIELD)
7	NC		
8	NC		
9	A-		
10	Z-		
11	B-		
12	5V RTN		
13	NC		
14	NC		
15	NV		

**CABLE: FLYING LEAD (3m LG)
BUILD-IN CONTROLLER**

J7 - HDP-26P MALE CONN.		J6 - DB-9S CONN.		J8 - FERRULE	
PIN	DETAIL	PIN	DETAIL	COLOR	DETAIL
1	INPUT COMMON (0V)	1	NC	RED	POWER +
2	OUTPUT SOURCE VOLTAGE (+24V)	2	TX	BLK	POWER -
3	GPI2	3	RX		
4	GPI0	4	NC		
5	GND	5	GND		
6	STO_FB	6	NC		
7	AN_OUT	7	NC		
8	GPO2	8	NC		
9	GPO0	9	NC		
10	STO2				
11	STO1				
12	GPI3				
13	GPI1				
14	GND				
15	NC				
16	NC				
17	GPO3				
18	GPO1				
19	+5V				
20	+5V				
21	+5V				
22	+5V				
23	GND				
24	AN_IN+				
25	AN_IN-				
26	STO COMMON				

REF. NUMBER	LDA40
CONTRACT	LDA40

UNLESS OTHERWISE SPECIFIED
ALL DIMENSIONS ARE IN MM
BREAK EDGES AND REMOVE BURRS
TOLERANCES
X: ±0.5 X.X: ±0.1
X.XX: ±0.03 ANGLE: ±0.1°
CONCENTRICITY: ±0.025
ROUNDNESS: ±0.025
EDGE BREAKS: 0.2 MAX
ALL DIMENSIONS AND TOLERANCES ARE FINAL

MATERIAL:
FINISH:
MACHINE FINISH: 1.6
INTERPRET PER: ASME Y14.5-2009
THIRD ANGLE PROJECTION

NAME	DATE
DWN BY: TV	09/20/21
CHK BY: TV	09/20/21
ENG APP: TV	11/23/21
MFG APP	
QA APP	

PROPRIETARY AND CONFIDENTIAL

THE INFORMATION CONTAINED IN THIS DRAWING IS THE SOLE PROPERTY OF SMAC. ANY REPRODUCTION IN PART OR AS A WHOLE WITHOUT THE WRITTEN PERMISSION OF SMAC IS PROHIBITED.

SMAC 5807 VAN ALLEN WAY
CARLSBAD CA, 92008
(760) 929-7588

TITLE: MOVING COIL ACTUATORS

SIZE: B PART NO: REV: C

SCALE: 1:1 DO NOT SCALE SHEET: 2 / 2